



4 AXIS CNC MACHINING CENTER WITH AUTOMATIC TRANSFER SYSTEM FOR WORKPIECES



Routing / drilling / grooving / milling / polishing...



T818 M4 TOPS 400 4 AXES

V0817 137

The aim of this chapter is to give you technical and functional information on the machine as well as on the options and accessories. You will find in this document the different selected quantities and options. In order to improve continuously the quality of our machines, the characteristics given in these pages may change at any moment and without previous notice. All the pictures and sketches of this document are used for illustrative only.

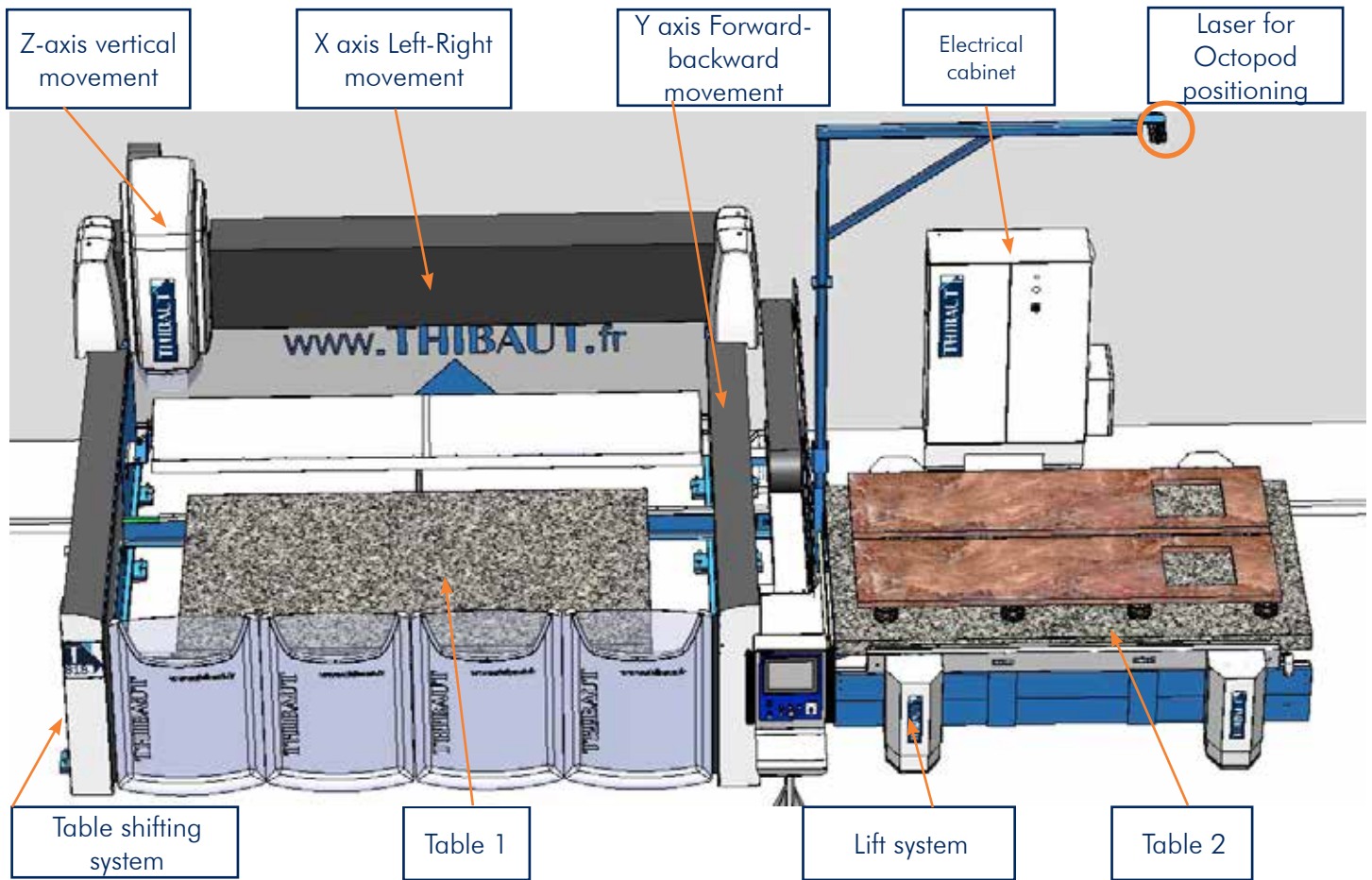

Transfer table operating system

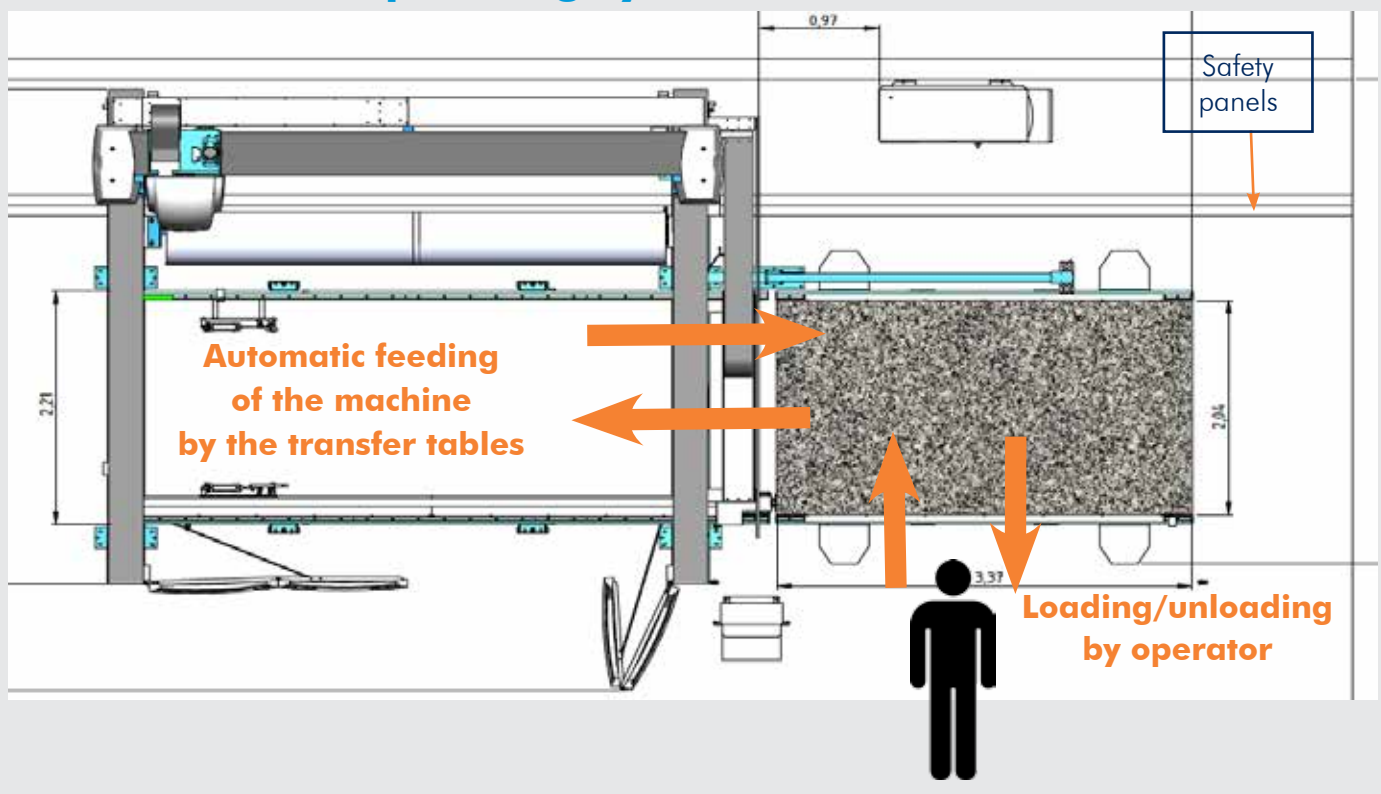

ASSETS

Let's increase your productivity thanks to this unique system enabling a work in dead-times on two tables. Reduce your investment and spare in dimensions while installing one machine rather than two of them.

The machine is equipped with the « Octopod » clamping system : a revolution !

A PERFORMING TRANSFER-TABLES SYSTEM

Its transfer table system increases the productivity, enabling a work in dead-times.

The operator positions the slabs on the loading/unloading table (laid on the right or left) while the machine is machining on the other table.

The transfer of tables is made automatically and the stopping time of the machine is limited to the transfer time of the tables.

Once workpieces are machined, the operator unloads them and cleans the table in dead-times.

In case of specific workpieces, loading of pieces can be made directly at the front of the machine while activating the doors.

Working tables are in granite and largely sized. They ensure a better clamping, an easy maintenance, long life and finally an improvement of the working quality (absorption of the vibrations). They moreover offer (in comparison with the turning tables) a bigger rigidity and reduced dimensions in width.

A GENUINE PRODUCTION CENTER WITH HIGH CAPACITY

The T818V3 is a product of the THIBAUT range which has been developed for more than 10 years and which has followed the technical and technological evolutions, which makes the machine the more performing of the market.

Its main technical qualities are the beam dimensions, its capacities on axes X, Y and Z, the different possible options which can be adapted (magazine, B head, angle drive...)

QUALITY, PRECISION AND RELIABILITY

The machinings and drillings on the beam are made in one operation thanks to a very new CNC machining center of high capacity.

This process permits a concise work and a perfect alignment of the rails which means, for you, precision and longevity for your T818.

On another hand, all elements, including the beam, are widely dimensioned to ensure a perfect rigidity.

A REVOLUTION : THE OCTOPOD CLAMPING SYSTEM



Positioning of the Octopod and the slabs is facilitated by the laser above the loading table which indicates the position of the vacuum pods.

The Octopod system enables to save 50% clamping time.

This system is working without hoses, vacuum pump : moving of the transfer tables is easy.

TECHNICAL DESCRIPTION : MACHINE

Working capacities :

- Y longitudinal stroke = 2200 mm
- X traverse stroke = 3550 mm
- Z vertical stroke = 400 mm
- Automatic tool changing by BT40 cone (maximum weight of arbor + tool in the spindle is 15 kg)
- Tool wear out dynamic compensation (radius)
- Vertical compensation for machining of non calibrated slabs.

X axis (transversal movement) :

- Welded structure traverse carriage equipped with a vertical linear table supporting the spindle.
- Traverse shifting ensured by brushless brake gear motor (variable speed).
- Traverse driving by precision pinion/rack with inclined teeth.

Y axis (longitudinal movement) :

- Painted welded structure plinths with linear rails and protection bellows.
- Welded structure beams with linear rails and protection bellows.
- Longitudinal Y axis shifting ensured by 2 brushless brake gear motors with electronical synchronisation (variable speed).
- Longitudinal driving thanks to precision pinion/rack systems with inclined teeth.

Z axis (vertical movement) :

- Vertical shifting (axis Z) of the spindle support linear table ensured by brushless brake motor (variable speed).
- Vertical driving by ball screw and precision linear guiding (axis Z) protected by bellows.

Spindle motor :

- Spindle motor 13,7 kW (S6) from 250 to 10000 rpm

Feedings :

- Voltage : 400 V/50 Hz.
- Air filtration 5 with automatic draining system.
- Water filtration by filter 50 μ m for central watering.
- Double watering : central watering (clear water) for cooling of the spindle and lubrication of the tool external watering by crown equipped with flat jet nozzles for tool lubrication.

Automatic centralized Oiling system :

- Oiling system feeding the linear guidings X, Y, Z as well as Z axis ball screw.

Automatisme et pilotage de la machine :

- Air-conditionned electrical cabinet placed on the right side.
- Control board integrating the CNC equipped with a 15 » TFT colour touch-screen

Safety :

- Safety doors at the front of the runway prohibiting access to the working area.

Assistance and diagnosis by telemaintenance :

Allows our After Sale Service to take remote control of the machine and of the CAD/CAM from any computer via Internet thanks to a quick and sure connection.

Includes the remote connection software installed on the machine.

Note : No cost of phone calls, only your Internet subscription. Functioning without any problem thanks to firewalls, you just need to connect the machine to the Internet.

The Internet connection as well as the safeties (Firewall and Antivirus) need to be supplied by the customer.

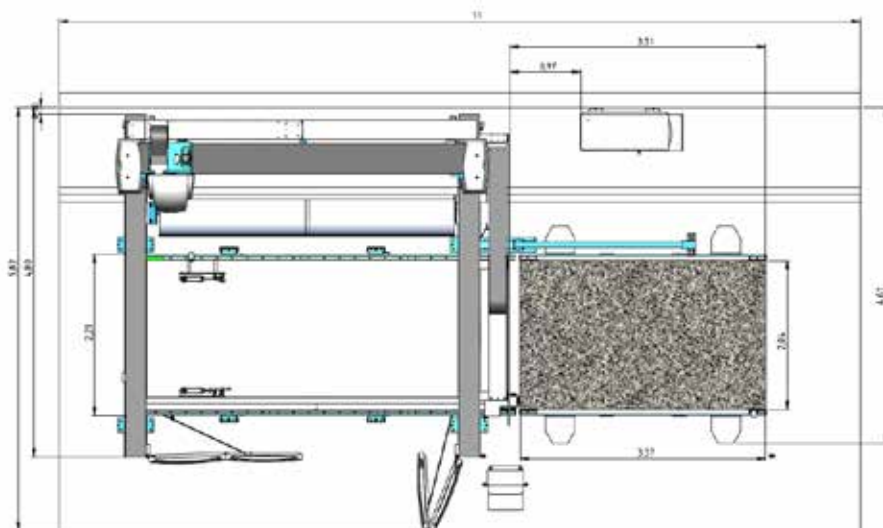

ALL IN DIMENSIONS DRAWINGS

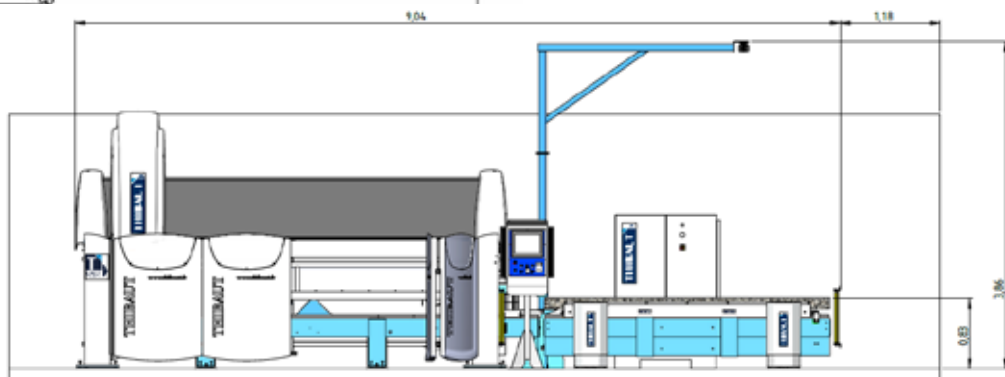

TECHNICAL DESCRIPTION : TRANSFER TABLES

Working capacities :

- Table capacity : 2040mm x 3375 mm.
- Workpieces maximum height : 50 mm.

Technical features :

- Ergonomic table height : 813 mm from the ground.
- Table driving by pulley / belt.
- Table indexing system in working position for a concise positioning which can be repeated.
- Hydraulic cylinder for table up and down system.
- Fully reversible system, installation is possible either on the right or left side of the machine.

Laser for clamping system positioning :

- Laser positioned above the loading/unloading zone.
- Indicated position of the Octopod vacuum pods to be put on the table for clamping of the pieces.

Safety :

- Safety area with barriers enabling safe loading/unloading in dead times.

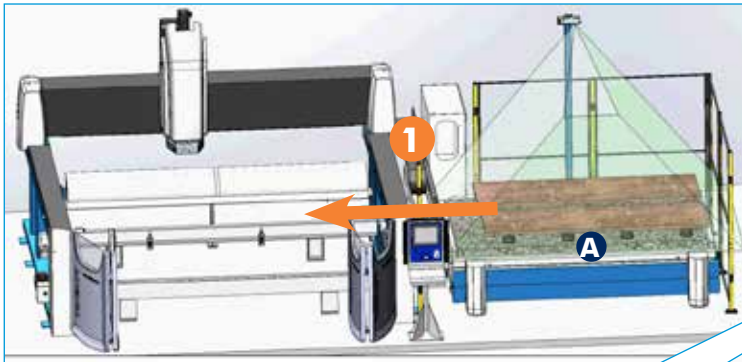

Loading of the pieces by the operator on table A, then transfer of the table into the machining zone.

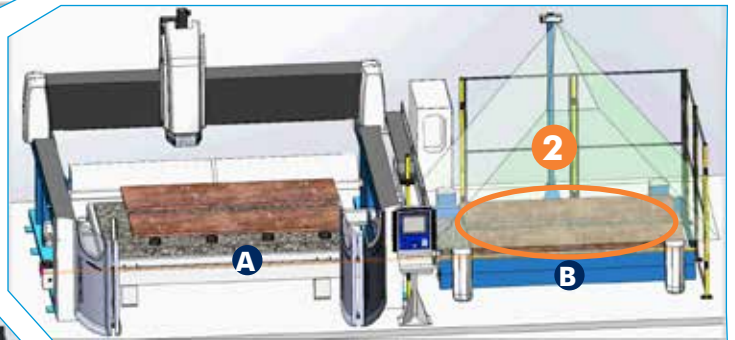

Setting up the Octopods and slabs on table B while machining the workpieces on table A.

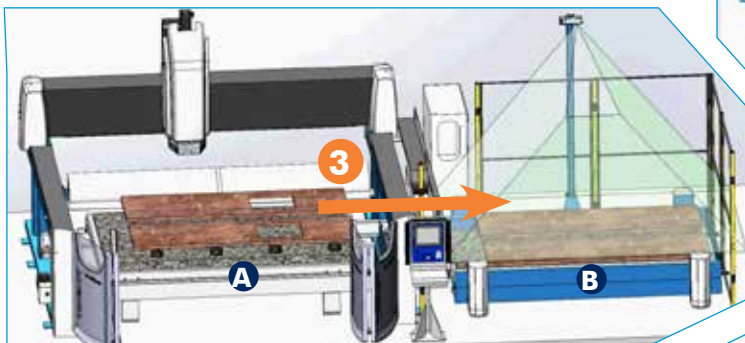

After machining, table A is transferred to the loading / unloading area.

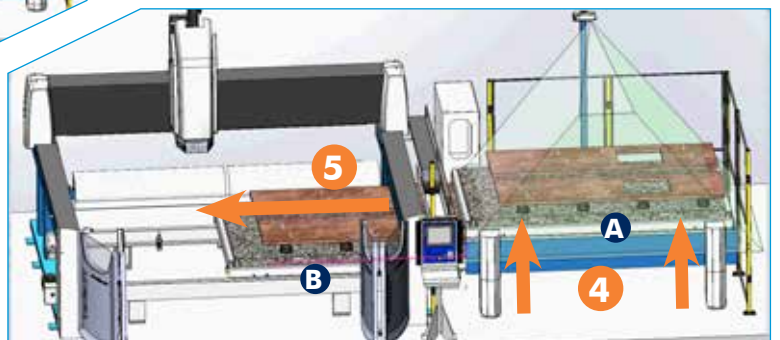

Transfer table B into the machining zone while the operator unloads the pieces on table A.

PROGRAMMING

F

eT'CAM (option) : 2D milling software

2D software specifically designed for countertops or simple dimensional workpieces.

eT'cam is a simple programming software specially designed for use directly from the machine's touch screen. Developed 100% internally by Thibaut, this software meets the business requirements of decoration and funeral. Very fast programming through dxf. files importation, parametric forms, sensing with laser of the machine. Software running under Windows. The license allows the use of the software on the machine and on another PC of your choice.

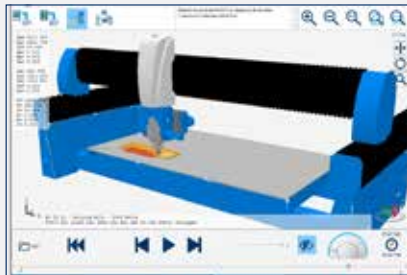
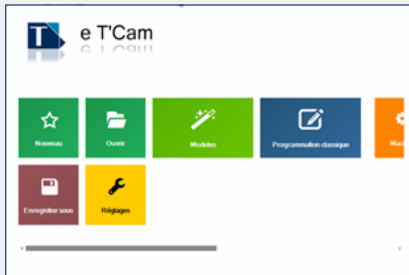
**G**

T'CAD / T'CAM (option) : cutting and milling full 3D software

Thanks to a computer and T'Cad/ T'Cam software :

T'Cad/T'Cam is available in 2 versions :

- Pack 1 : To program machining with disc or with cutter (3 + 2 interpolated axes).
- Pack 2 : To program complex machining (5 interpolated axes).

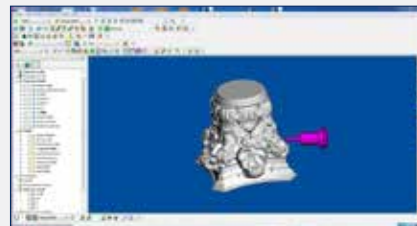
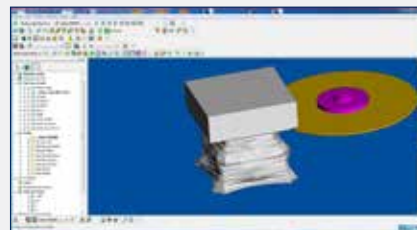
**H**

T'ART (option)

2D & 3D software specially designed for engraving & bas-reliefs.

T'ART 2D

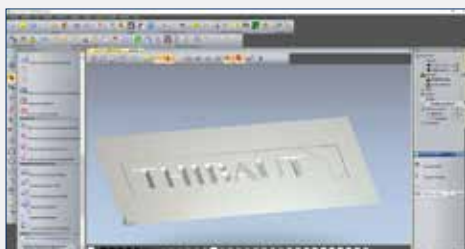

T'ART 3D

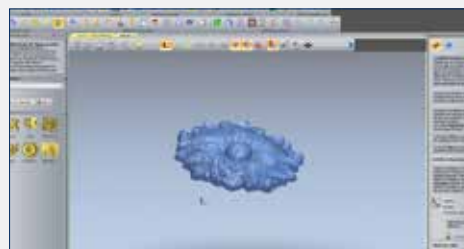

"OCTOPODS" CLAMPING SYSTEM

CLAMPING WITH OCTOPOD EXCLUSIVELY



octopod
by THIBAUT

*The new revolution in
the clamping system*



Ø114 mm / 4.49"



Ø154 mm / 6.06"

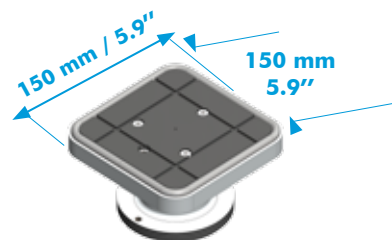
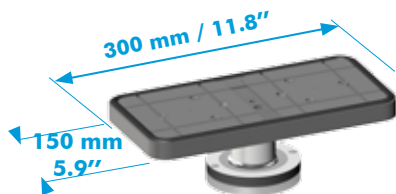

EXCLUSIVE FUNCTIONS

Modulo

1 angle drive = 3 applications with automatic tool change.

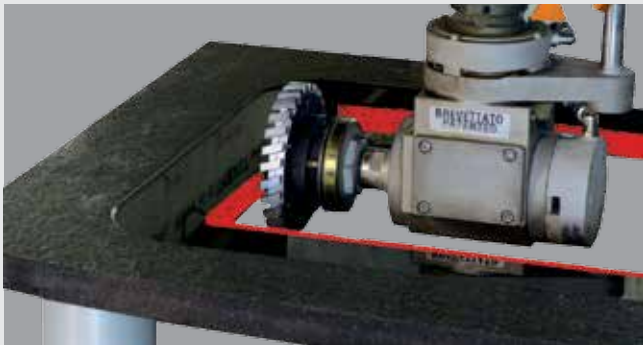
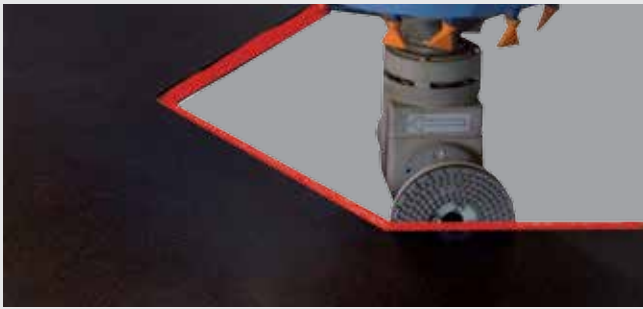

Pneumatic pressure

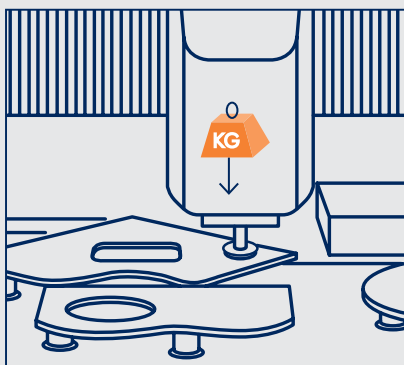

Pneumatic pressure enables to obtain an unequalled polishing quality. The pneumatic pressure is programmable and adjustable according to the tools grains. The tool is in perfect contact with the material to work with.

B3 head

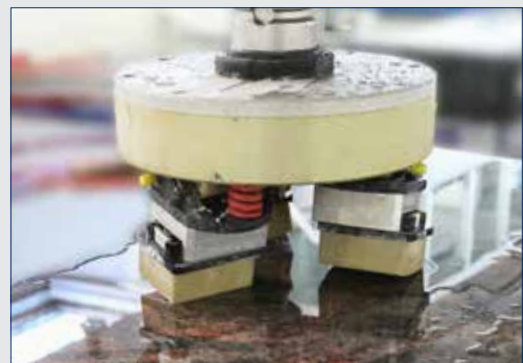

B3 head with oscillating segments (Pad disc 70 mm long). Ideal for hard sursides or repolishing scratched surside.

T818 M4 TOPS 400 4 AXES

COUNTERTOPS APPLICATION



COUNTERTOPS APPLICATION

